



LET'S GET
YOU SET UP

USER GUIDE



Download the SmartKnight App

On Google Play (Android™) or App Store® (Apple®).
Open the app, tap "Register" and follow the on-screen instructions



Add Device

(2.4 Ghz only)

To add a device tap the "+" on top right corner, select the product category and follow the on-screen instructions



Enjoy

Enjoy your connected product. For more in-depth instructions, please see section titled "Wi-Fi Control" in this leaflet



Setting up Voice Assistants



Enable the "SmartKnight" skill in either voice assistant and follow the app instructions to control your device(s) with your voice.

Visit <http://www.mlaccessories.co.uk> for further assistance



INSTALLATION & MAINTENANCE MANUAL

WD12RGBW

GENERAL INSTRUCTIONS

These instructions should be read carefully and retained after installation by the end user for future reference and maintenance.

These instructions should be used to aid the installation of the following products:
WD12RGBW

SAFETY

- This product must be installed in accordance with the latest edition of the IEE Wiring Regulations (BS7671) and current Building Regulations. If in any doubt, consult a qualified electrician
- Please isolate mains prior to installation or maintenance
- Check the total load on the circuit (including when this luminaire is fitted) does not exceed the rating of the circuit cable, fuse, or circuit breaker
- Please note the IP (Ingress Protection) rating of this luminaire when deciding the location for installation
- If used under insulation, the insulation should be laid unbroken over the luminaire (not packed around it). Only mineral wool style insulation may be used
- This product is for indoor use only
- This product is Class II double insulated
- This product is IP44 rated (IP20 from above)

INSTALLATION

Note – Please note that this luminaire is incompatible with dimmers.

- Provide power to the required point of installation
- Cut a suitable hole in the mounting surface as per the cut-out details (see Fig. 1) ensuring not to infringe with any joists, gas/water pipes or electrical cables

Fig. 1

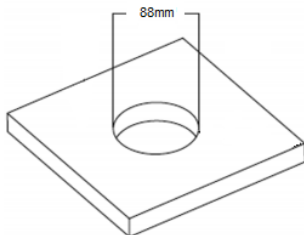

- Insert a flat-head screwdriver into the access slots on the rear of the driver then carefully push to remove the cover to access the mains terminal block
- Connect the luminaire to the mains supply ensuring the correct polarity is observed (see Fig. 2):
L - Live (Brown), E - Earth (Green/Yellow), N - Neutral (Blue). The earth terminal is non-functional and only provided for convenience

Fig. 2

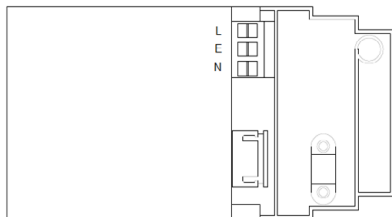

- Refit the terminal cover securely
- To change the bezel, turn anti-clockwise and remove, align the new bezel with the front of the luminaire and turn clockwise
- Lift both of the spring clips on the sides of the luminaire and push into the ceiling
- Switch on and check for correct operation

Note – Please note that it is normal for the luminaire to flash when switched on for the first time. When the luminaire is flashing, it means that it is in pairing mode.

WARNING

This product must be disconnected from the circuit if subjected to any high voltage or insulation resistance testing. Irreparable damage will occur if this instruction is not followed.

ADDITIONAL ACCESSORIES

Code	Model
WD12BC	Bezel - Brushed Chrome



GENERAL

The light source of this luminaire is not replaceable; when the light source reaches its end of life the whole luminaire should be replaced.

Clean with a soft dry cloth only, do not use aggressive cleaning products or solvents that may damage the product.

This product is dimmable via app only.

This product should be recycled in the correct manner when it reaches the end of its life. Check local authorities for where facilities exist.

WI-FI CONTROL

- Download the SmartKnight app from Google Play Store® or the App Store®
- Once the app is downloaded, open the app and tap "Register" then follow the on-screen instructions
- To add a luminaire to the app, switch on the power to the fitting and tap "+" on the top right corner
- Select "**Lighting**"
- Connect to the desired Wi-Fi network and tap "**Next**". Please note only 2.4 GHz networks are supported and make sure your device is connected to the same Wi-Fi network
- If the light is flashing rapidly, skip the reset procedure and tap "**Confirm the light is flashing rapidly**" and then tap "**Next**". If the light is not flashing, follow the on-screen instructions to reset it
- After the luminaire has been added successfully to the app, it can be named and added to a room. After naming the luminaire, tap "**Done**"

WARRANTY

This product has a warranty of 2 years from the date of purchase. Failure to install this product in accordance with the current edition of the IEE Wiring Regulations (BS7671), improper use, or removal of the batch code will invalidate the warranty. If this product should fail within its warranty period, it should be returned to the place of purchase for a free of charge replacement. ML Accessories does not accept responsibility for any installation costs associated with the replacement product. Your statutory rights are not affected. ML Accessories reserve the right to alter product specification without prior notice.

Amazon, Alexa and all related logos are trademarks of Amazon.com, Inc. or its affiliates.

Google, Android and Google Play are trademarks of Google LLC.



ML Accessories Limited LU5 4LT
www.mlaccessories.co.uk

INTERNATIONAL CONTACT DETAILS

