



INSTALLATION & MAINTENANCE MANUAL

**EXPF**

## GENERAL INSTRUCTIONS

**These instructions should be read carefully and retained after installation by the end user for future reference and maintenance.**

**These instructions should be used to aid installation of the following product:  
EXPF**

## SAFETY

- This product is intended for normal domestic/household use only
- Never install the unit where it could be subject to:
  - heat sources such as radiators, cookers, or stoves
  - direct sunlight
  - mechanical vibration or shock
  - excessive dust
  - lack of ventilation, such as inside a cabinet or bookcase
  - immersion in liquid or exposure to splashing
  - objects which may be pulled into the airstream such as curtains
- This product should not be left running unattended
- Avoid contact with moving parts. Do not insert any body parts or objects through the grill when the fan is operating
- Do not cover the grill or operate in proximity of curtains, drapes, etc

- This product should not be operated if it has been dropped, damaged or shows signs of malfunction
- This product must be switched off and unplugged before assembling or disassembling
- This product must be used on an even and stable surface to avoid overturning
- Please note the IP (Ingress Protection) rating of this product when deciding the location for installation
- This product is for indoor use only
- This product is Class II double insulated
- This product is IP20 rated

## PRODUCT ASSEMBLY

Note – Please note that this product is not designed to be used by persons (including children) with reduced physical, sensory, or mental capabilities, or lack of experience and knowledge, unless they have been given supervision or instruction

- Provide power to the required point of installation (a 13A socket is required per unit)

1. Front grille
2. Blade cap
3. Blade
4. Plastic mounting nut
5. Rear grille
6. Motor shaft
7. Oscillation control
8. Motor housing
9. Switch box
10. Set screw
11. Inner tube
12. Height adjustment collar
13. Outer tube
14. Base decorative cap
15. Screw (4pcs)
16. Bar A
17. Bar B
18. Screw
19. Buttons

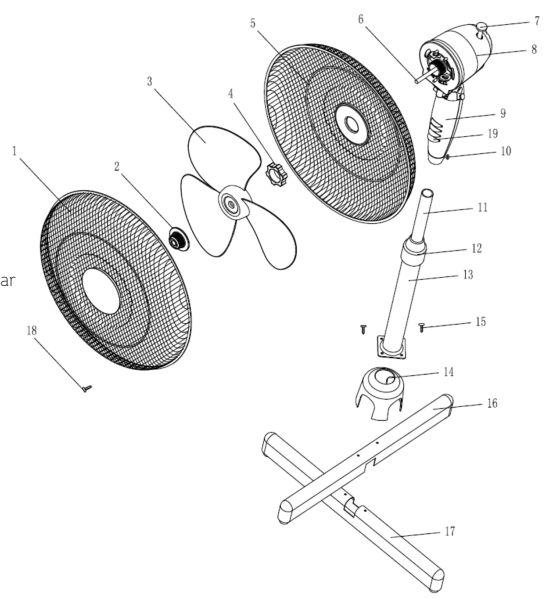

- Loosen and remove the four screws from the bars. Then cross bar A (16) and bar B (17) so that they interlock
- Align the four holes in the bars with those on the flange of the outer tube (13). Secure the flange to the bars with the four screws
- Loosen and remove the height adjustment collar (12) from the top of the inner tube (11). Slide the base decorative cap (14) down over the assembly
- Replace the height adjustment collar (12) on top of the inner tube (11). Pull the inner tube (11) out from the outer tube (13) to adjust the tube to the desired height and tighten the collar
- If necessary, slightly loosen the set screw (10) by turning it anticlockwise. Slide the switch box (9) down over the inner tube (11) and tighten the set screw (10)
- Switch on and check for correct operation

## WARNING

This product must be disconnected from the circuit if subjected to any high voltage or insulation resistance testing. Irreparable damage will occur if this instruction is not followed.

## GENERAL

Clean with a soft dry cloth only, do not use aggressive cleaning products or solvents that may damage the product.

This product should be recycled in the correct manner when it reaches the end of its life. Check local authorities for where facilities exist.

## WARRANTY

This product has a warranty of 1 year from the date of purchase. Failure to install this product in accordance with the current edition of the IEE Wiring Regulations (BS7671), improper use, or removal of the batch code will invalidate the warranty. If this product should fail within its warranty period, it should be returned to the place of purchase for a free of charge replacement. ML Accessories does not accept responsibility for any installation costs associated with the replacement product. Your statutory rights are not affected. ML Accessories reserve the right to alter product specification without prior notice.

### SUPPLIED BY:

**(UK) MANUFACTURER ML ACCESSORIES LTD, UNIT E CHILTERN PARK,  
BOSCOMBE ROAD, DUNSTABLE LU5 4LT,  
WWW.MLACCESSORIES.CO.UK**

**(EU) AUTHORISED REPRESENTATIVE SLV LIGHTING GROUP,  
DAIMLERSTRASSE 21-23, 52531 ÜBACH-PALENBERG, GERMANY  
EMAIL: EPREL@GROUP.SLV.COM  
MADE IN CHINA**

230V  
50Hz

IP20



50W

**ML**  
ACCESSORIES LTD



**UK  
CA** **CE**



106

AVOCT25\_V2