



INSTALLATION & MAINTENANCE MANUAL

KLSUSBK / KLSUSW

GENERAL INSTRUCTIONS

These instructions should be read carefully and retained after installation by the end user for future reference and maintenance.

**These instructions should be used to aid installation of the following product:
KLSUSBK / KLSUSW**

SAFETY

- This product must be installed in accordance with the latest edition of the IEE Wiring Regulations (BS7671) and current Building Regulations. If in any doubt, consult a qualified electrician
- Please isolate mains prior to installation or maintenance

INSTALLATION

- Fit aluminium block to ceiling/flat surface (see Fig. 1A)
- Mount steel suspension wire into block. Feed plastic cup from other end of suspension wire, push all the way up until it covers the block. (see Fig. 1B)
- Tighten the screw to secure cup in place (see Fig. 1C)

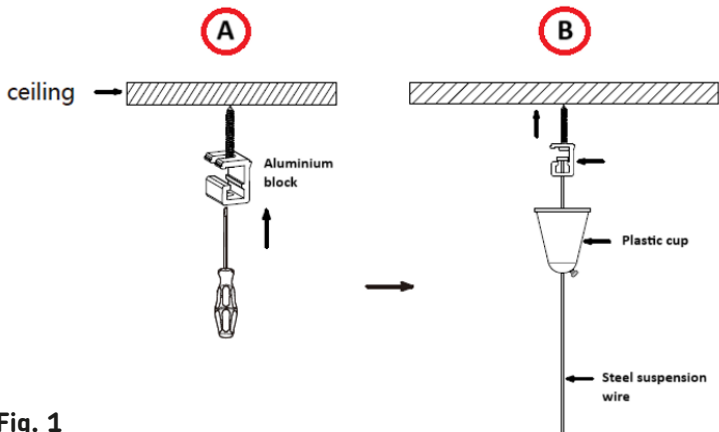

Fig. 1

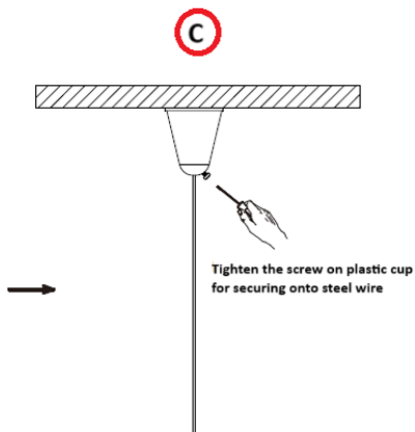

Fig. 1

- Fit suspension accessory onto track bracket. Adjust bracket width by using a screwdriver and mount onto track from end (Fig. 2A)
- Slide bracket along track to required place then secure by tightening screw (Fig. 2B)

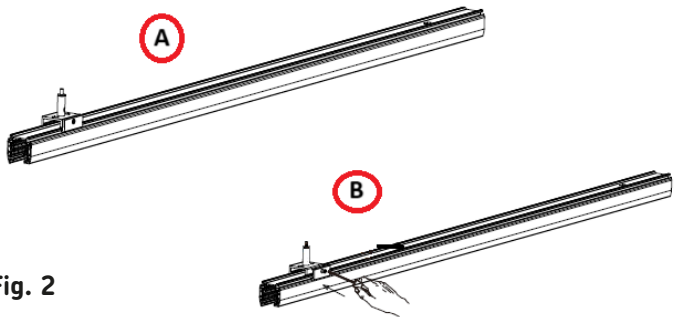

Fig. 2

- Push each suspension wire hanging from the ceiling fixings into one of the adjustment connectors (thread locker) until it appears out of the hole in the side (see Fig. 3)

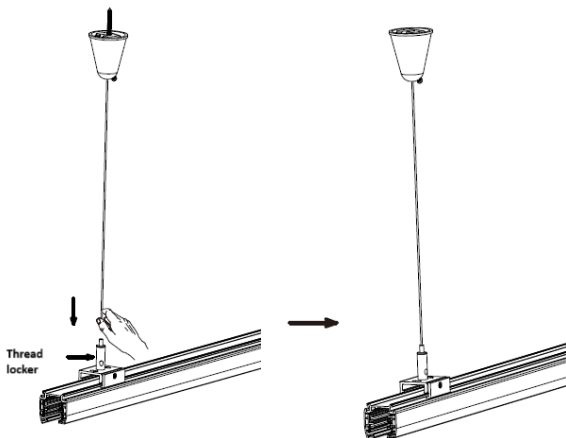

Fig. 3

- The height of the track can be raised by pushing suspension wire down through the adjustment connector and can be raised by pulling up while pressing top of connector.
- Once the desired height has been achieved, the wire may be trimmed to within 10mm of the hole in the adjustment connector and a strain relief connector fitted for security. Make sure screw is tightened for firm grip.
- Maximum weight supported by pair of this kit 25kg
- Recommended number of kits for track lengths 1M = 2 kits, 2M = 3 kits, 4M = 4 kits

GENERAL

This product should be recycled in the correct manner when it reaches the end of its life.

Check local authorities for where facilities exist.

Clean with a soft dry cloth only, do not use aggressive cleaning products or solvents which may damage the product.

WARRANTY

This product has a warranty of 1 year from date of purchase. Failure to install this product in accordance with the current edition of the IEE Wiring Regulations (BS7671), improper use, or removal of the batch code will invalidate the warranty. If this product should fail within its warranty period, it should be returned to the place of purchase for a free of charge replacement. ML Accessories does not accept responsibility for any installation costs associated with the replacement product. Your statutory rights are not affected. ML Accessories reserve the right to alter product specification without prior notice.

SUPPLIED BY:

(UK) MANUFACTURER

ML ACCESSORIES LTD, UNIT E CHILTERN PARK,
BOSCOMBE ROAD, DUNSTABLE LU5 4LT,
WWW.MLACCESSORIES.CO.UK

(EU) AUTHORISED REPRESENTATIVE

SLV LIGHTING GROUP,
DAIMLERSTRASSE 21-23,
52531 ÜBACH-PALENBERG, GERMANY
EMAIL: EPREL@GROUP.SLV.COM

MADE IN CHINA

IP20

ML
ACCESSORIES LTD



**UK
CA**



155