



INSTALLATION & MAINTENANCE MANUAL

WPASCWA

GENERAL INSTRUCTIONS

These instructions should be read carefully and retained after installation by the end user for future reference and maintenance.

**These instructions should be used to aid installation of the following product:
WPASCWA**

SAFETY

- This product must be installed in accordance with the latest edition of the IEE Wiring Regulations (BS7671) and current Building Regulations. If in any doubt, consult a qualified electrician
- Please isolate mains prior to installation or maintenance
- Check the total load on the circuit (including when this luminaire is fitted) does not exceed the rating of the circuit cable, fuse or circuit breaker
- Please note the IP (Ingress Protection) rating of this product when deciding the location for installation
- Do not overload this accessory or subject it to conditions outside its rating
- This product is Class I and must be earthed
- This product is IP65 rated

INSTALLATION

Note - If this luminaire is being used in conjunction with an external PIR or sensor, please confirm with the manufacturer of the sensors that they are compatible with LED lamps/ luminaires.

- Provide power to the required point of installation (refer to BS7671 for correct cabling methods). Suitable IP rated junction boxes should be used where required
- The power source connections should be local and accessible via a suitable IP rated enclosure
- Round cable should be used for the mains supply. The use of flat cable will cause water ingress to the fitting
- Mark the location of the fixing holes and drill the holes ensuring not to infringe with any gas/water pipes or electrical cables. The fitting can also be mounted over conduit boxes
- Unscrew the four front screws to gain access (see Fig. 1)

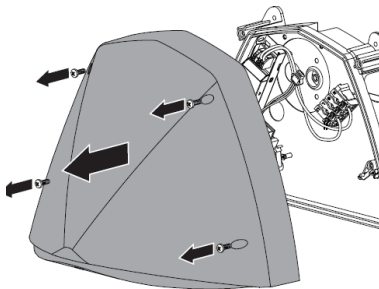

Fig. 1

- Feed the mains cable through the rubber grommet to retain IP rating, and secure the baseplate to the surface
- Fix the base to a suitable solid surface using the screws provided. Rubber washers or sealant should be applied around the screw heads to prevent water ingress
- Replace the access plate and screws ensuring it is secured to the luminaire casing
- Using an appropriate junction box (not included), connect the luminaire to the mains supply ensuring the correct polarity is observed: L – Live (brown), E – Earth (green & yellow), N – Neutral (blue) (see Fig. 2). Two cables can be inserted into the push-fit terminal block in order to achieve loop-in/loop out wiring



Fig. 2

- Secure the mains cable under the cable clamp and refit the terminal cover (see Fig. 3)

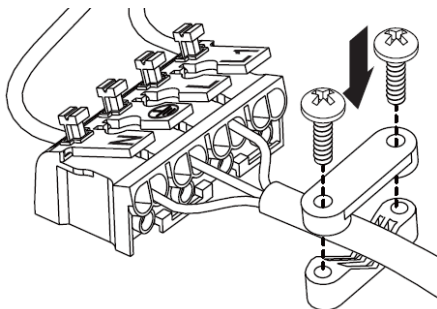

Fig. 3

- Select the required colour temperature via the three-position switch on the rear of the luminaire and required wattage on three position switches located on the driver (see Fig. 4)

CCT	WW 3000K	CW 4000K	DL 6500K
DIP Switch			

Iout	200mA	250mA	300mA	350mA
DIP Switch	1→ OFF 2→ OFF 3→ ON	1→ OFF 2→ ON 3→ OFF	1→ ON 2→ OFF 3→ OFF	1→ OFF 2→ OFF 3→ OFF
Power	14W	17W	21W	24W

Fig. 4

- If the photocell sensor is not required, disconnect the connectors labelled PH for the photocell sensor
- Refasten the cover (see Fig. 5)

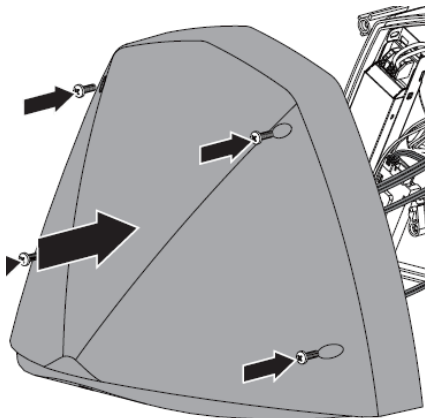

Fig. 5

- Switch on and check for correct operation

Note; This product has a soft start of approximately 3 seconds

WARNING

This product must be disconnected from the circuit if subjected to any high voltage or insulation resistance testing. Irreparable damage will occur if this instruction is not followed.

GENERAL

This product contains a light source of energy efficiency class E to Regulation (EU) No. 2019/2015 and (UK) 2021 No. 1095.

This product contains a non-replaceable LED light source and a control gear which can be replaced by a professional.

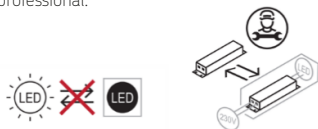

Clean with a soft dry cloth only, do not use aggressive cleaning products or solvents which may damage the product.

Clean the external surfaces with a damp cloth using a mild solution of detergent and warm water only, do not use aggressive cleaning products or solvents which may damage the product.

Do not use any source of high-pressure washers to maintain or clean this luminaire.

Installing in areas where the temperature consistently drops below 0°C may shorten the battery life.

This product should be dismantled for disposal when it reaches the end of its life. Please see website for dismantling instructions.

This product should be recycled in the correct manner when it reaches the end of its life. Check local authorities for where facilities exist.

WARRANTY

This product has a warranty of 5 years from date of purchase. Failure to install this product in accordance with the current edition of the IEE Wiring Regulations (BS7671), improper use, or removal of the batch code will invalidate the warranty. If this product should fail within its warranty period, it should be returned to the place of purchase for a free of charge replacement. ML Accessories does not accept responsibility for any installation costs associated with the replacement product. Your statutory rights are not affected. ML Accessories reserve the right to alter product specification without prior notice.

SUPPLIED BY:

(UK) MANUFACTURER

ML ACCESSORIES LTD, UNIT E CHILTERN PARK,
BOSCOMBE ROAD, DUNSTABLE LU5 4LT,
WWW.MLACCESSORIES.CO.UK

(EU) AUTHORISED REPRESENTATIVE

SLV LIGHTING GROUP,
DAIMLERSTRASSE 21-23,
52531 ÜBACH-PALENBERG, GERMANY
EMAIL: EPREL@GROUP.SLV.COM

MADE IN CHINA

230V
50Hz

IP65



>85
CRI

-20~
45°C
TA



ML
ACCESSORIES LTD



UK
CA



134